



DESCRIPTION:

CAT5E, RJ11 (6P4C) MODULAR PLUG, UNSHIELDED, SOLID/STRANDED, FLAT CABLE

MODEL NUMBER:

32-5954UL

APPLICATION:

MODULAR PLUG

CRIMP TOOL:

N/A

IMPEDANCE:

N/A

FREQUENCY RANGE:

N/A

MATERIAL:

HOUSING
CONTACT

CLEAR POLYCARBONATE UL94-V0
PHOSPHOR BRONZE
SELECTIVE GOLD PLATING

RoHS COMPLIANCE:

YES

TECHINCAL DETAIL:

N/A

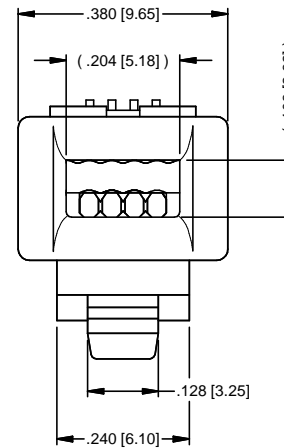
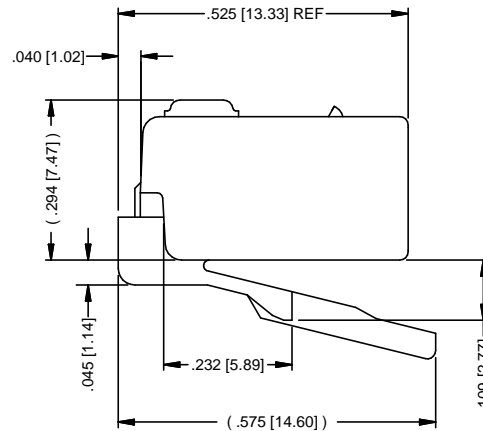
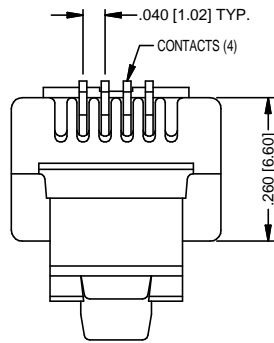
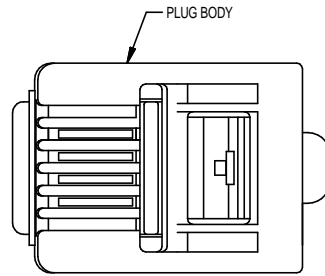

<p>This PROPRIETARY Document is property of Cinch Connectivity Solutions. It is confidential in nature, non-transferable, and issued with the clear understanding that it is not to be traded or copied without permission and is returnable upon demand.</p> <p>INTERPRET DRAWING IN ACCORDANCE WITH ASME Y14.5-2009.</p>		<h3>AIM-Cambridge</h3>	
	<p>RoHS2 <input checked="" type="checkbox"/></p> <p>2011/65/EU</p>	<p>Title: CAT5E, RJ11 (6P4C) Modular Plug, Unshielded, Solid/Stranded, Flat Cable</p>	
	<p>UNLESS OTHERWISE SPECIFIED UNITS: INCH</p> <p>.XX ±.02 .XXX ±.005 ANGLES ±2°</p>	<p>Model No. 32-5954UL</p>	
	<p>Size A</p>	<p>DO NOT SCALE DRAWING</p>	<p>Date: 2015/12/9</p>